

Self-Collect - HPV Specimen Collection for the Cervical Screening Program

As of July 1st 2022 any individual who is eligible for cervical screening, as a primary screen or follow up test (after an intermediate risk test 12 months earlier), will be eligible for a self-collect in place of a clinician collected sample.

Until July 1st, these were restricted to never-screened, or significantly under screened patients. This is a significant change to eligibility of this test.

Some patients are not eligible, specifically anyone who requires a co-test (cervical cytology). This includes:

- Symptomatic patients
- Patients attending for a test of cure (after histologically confirmed HSIL).
- Patients who have had previous AIS (endocervical adenocarcinoma in situ).
- DES exposed patients.
- Patients who have previously had gynaecologic cancer.

These patients still require a clinician collected cervical sample as they require both HPV testing (testing for the virus) and cytology co-testing (looking at the cells).

The laboratories cannot do any reflex liquid based cytology (LBC) on the sample if it is required.

If the HPV test is positive for HPV 16/18 the patient will need to be referred to a specialist.

If the HPV test is positive for other oncogenic HPV, the patient will need to return to their GP to have a (clinician collected) sample for LBC.

Request form must clearly state: **Self collect, cervical screening test.**

MATERIALS REQUIRED

For self-collect the following materials are required:

1. Dorevitch Pathology request form
2. Copan Floq swab (Red Top) - available from Dorevitch Pathology
3. Self-collect - HPV Specimen Collection of the Cervical Screening Program instructions (overleaf)
4. ThinPrep® vial

Self collect kits can be ordered from our website. Visit dorevitch.com.au/clinicians/order-consumables.

MEDICARE REBATE

Cervical screening requests that follow the National prescribed clinical guidelines will be bulk billed subject to Medicare guidelines and criteria.

>>> CONTINUED OVERLEAF

Self-Collect - HPV Specimen Collection for the Cervical Screening Program

>>> CONTINUED FROM OVERLEAF

SELF-COLLECTION

1. Use a flocked swab (Red Top) - do not use any lubricant.
2. Insert the flocked swab (Red Top) deep into vagina, not just the entrance.
3. Move around in a circular motion for about 10 rotations and then move around other areas deep in the vagina.
4. Immediately place the flocked swab (Red Top) back into the container and secure the cap.

Flocked swab (Red Top)

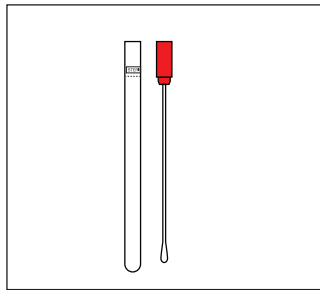
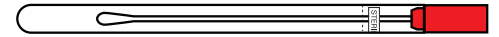

Step 1

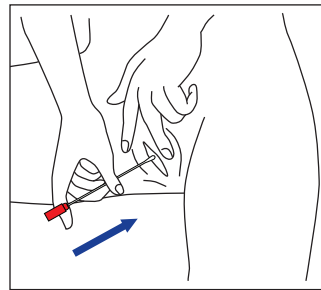

Step 2

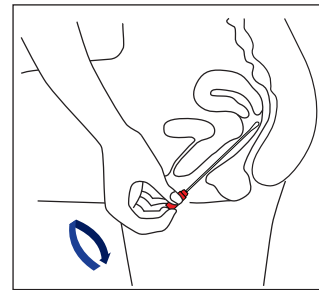

Step 3

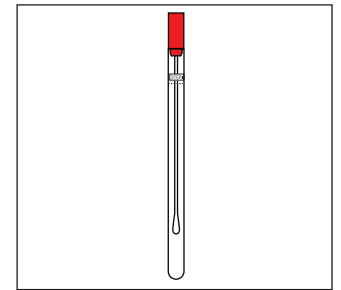

Step 4

5. Give directly to your health care provider, OR follow the steps below:

THE DOCTOR OR HEALTH CARE PROVIDER (OR PATIENT IF PREFERRED) MUST THEN

1. Slowly pull the swab cap off to remove the swab from the tube
2. Check that the ThinPrep® vial has not exceeded its expiry date.
3. Fully immerse the tip of the swab into the solution of the ThinPrep® vial
4. Swirl the swab for 20 seconds
5. Hold the tip against the inner vial wall to drain fluid from the swab
6. Place the swab back into the tube
7. Re-cap the ThinPrep® vial
8. Record the patients full name and date of birth on the ThinPrep® vial.
9. Complete the patient's details on the request form with all relevant information
10. Ensure **SELF COLLECTION, CERVICAL SCREENING TEST** is on the request form
11. Send the ThinPrep® vial to the laboratory in the usual manner.